

drawn left

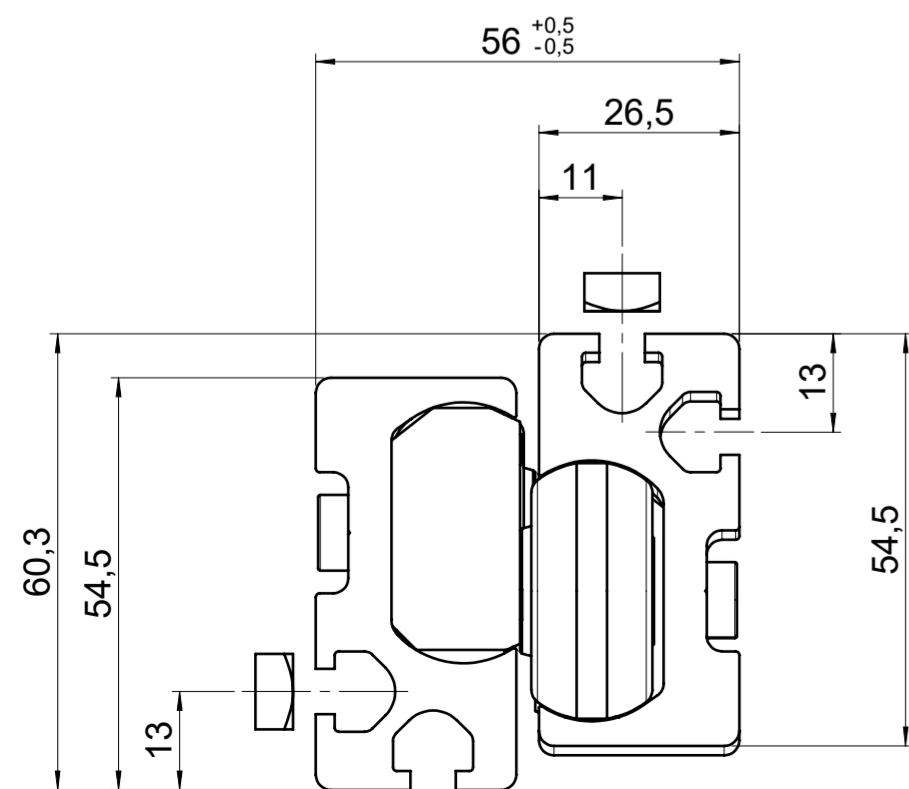
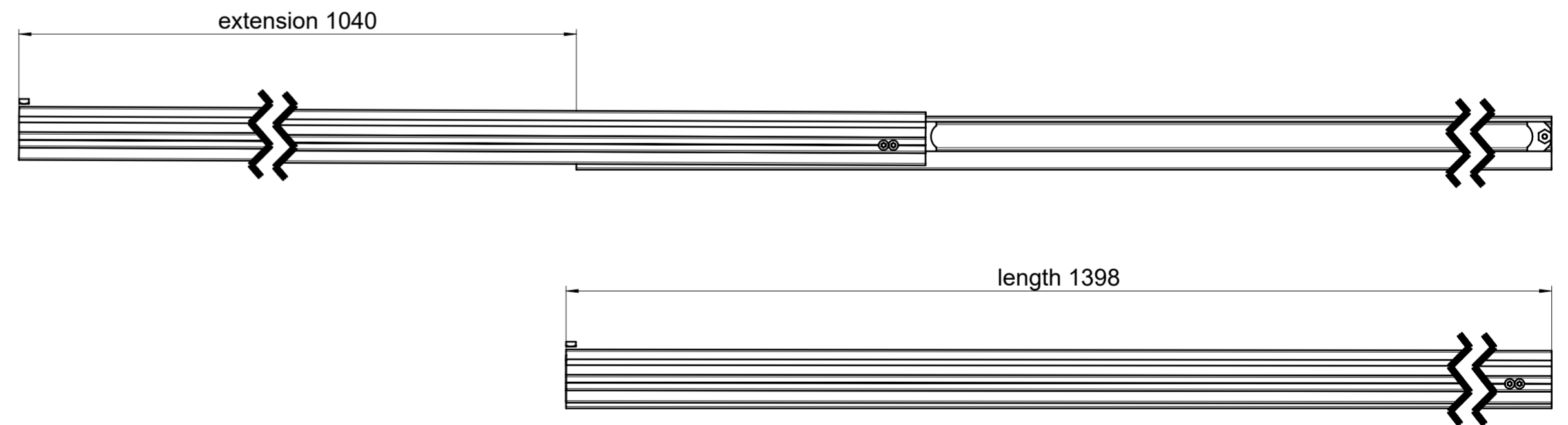
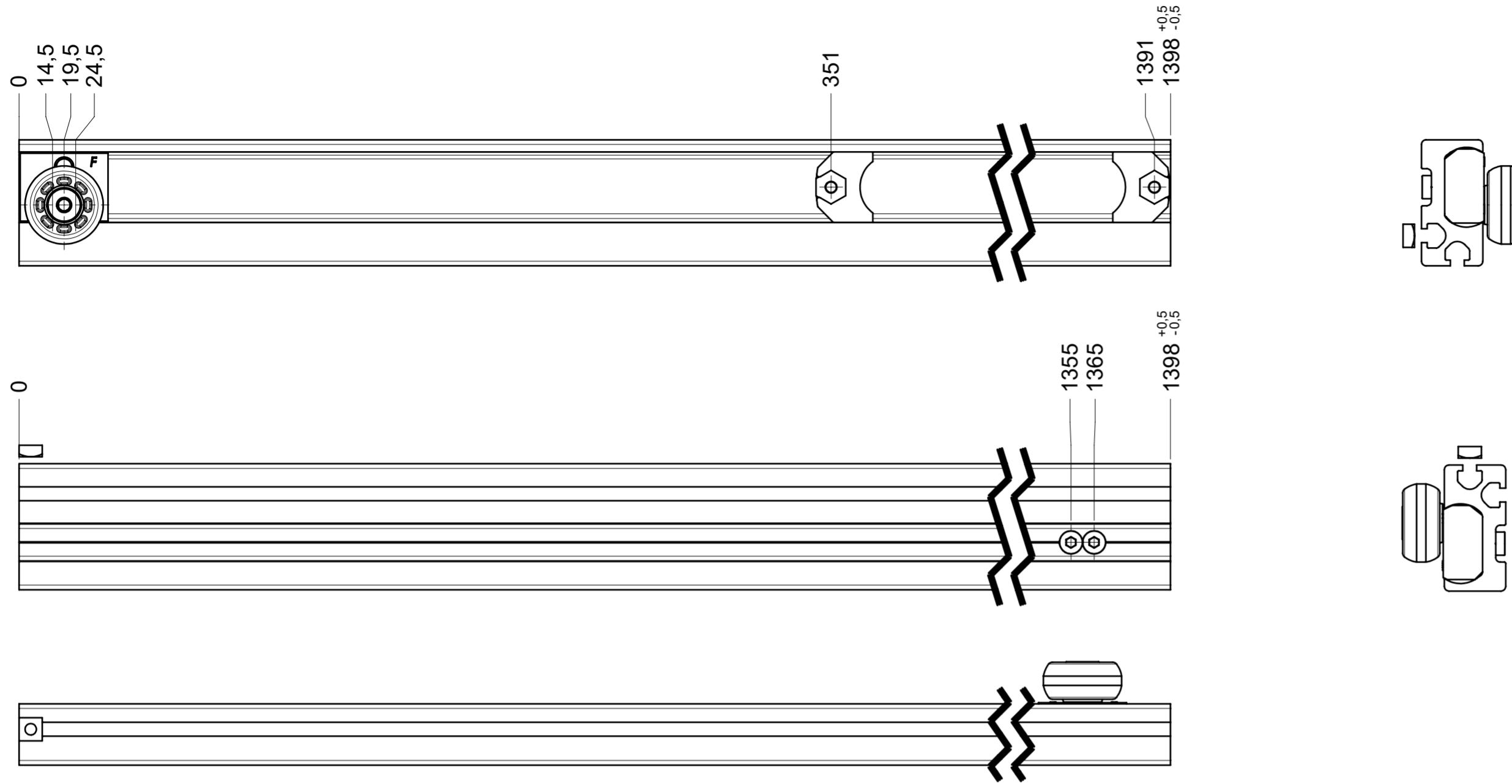

**final approval**

customer name:

signed by:

date:

all dimensions in mm				DIN ISO 128-30 missing dimensions see 3D = theor. intersection	
This drawing remains our property and may not be multiplied neither be disclosed to third parties (§§1,3 and 5 from the copyright Act (UrhG)) covered according to DIN ISO 16016					
scale: 1:2		surface:		material, semi finished parts: CS (technical requirements Fulterer)	
drawn 01-02-2023		date 01-02-2023		name ex	
proven 01-03-2023		date 01-03-2023		name pr	
				description: FR 9000 / 140 EN (mm) progressive-action full-extension drawerslide / side mount	
<b>Fulterer AG &amp; Co KG</b> A-6890 Lustenau / Austria <b>Fulterer AG</b> CH-9430 St. Margrethen				drawing number: 9000.1400-GA.0000.li	
changes				date	
na.				replaces version date:	

drawn right

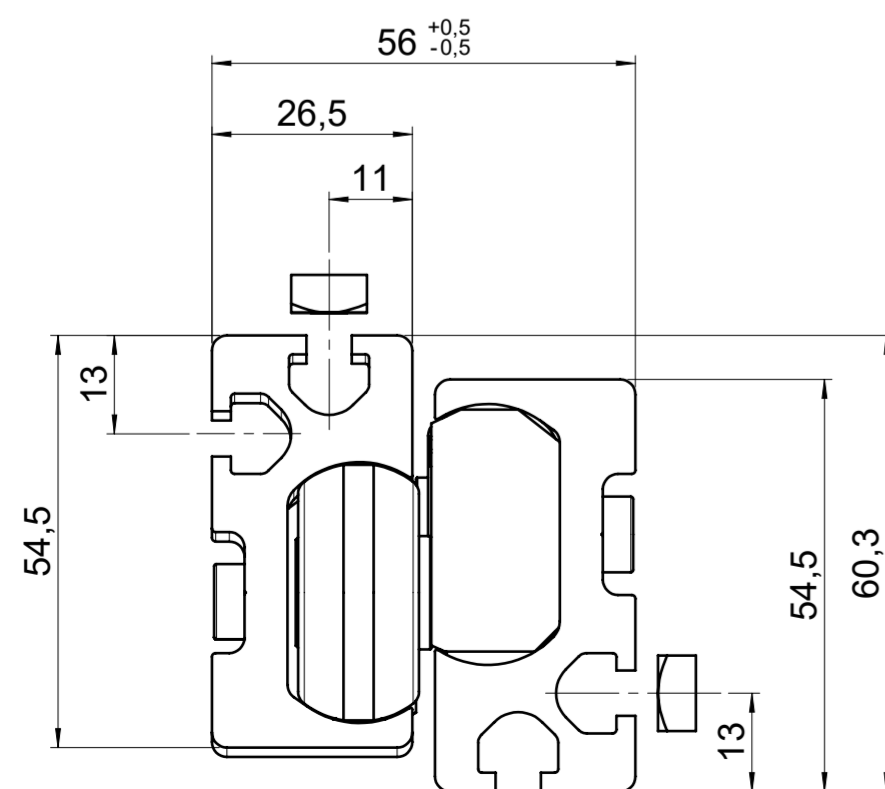
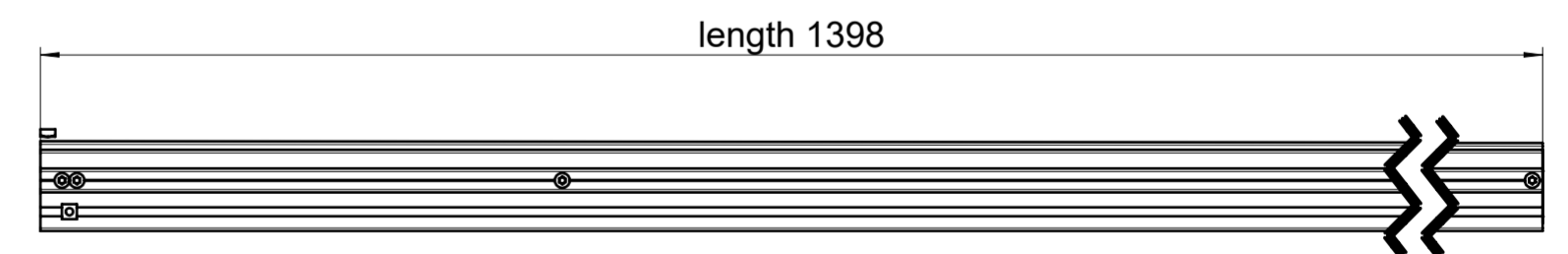
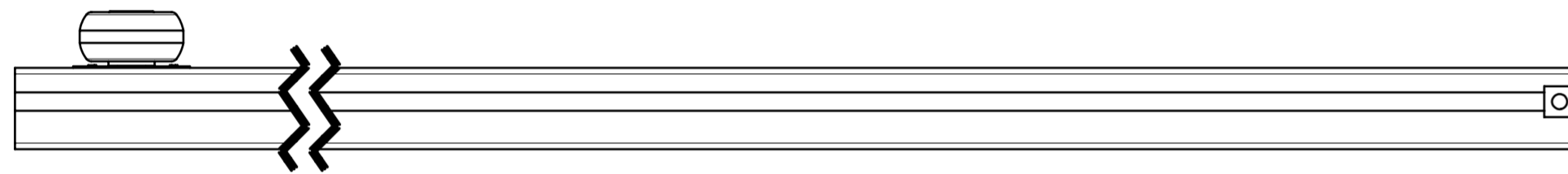
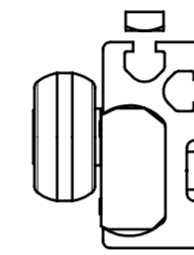
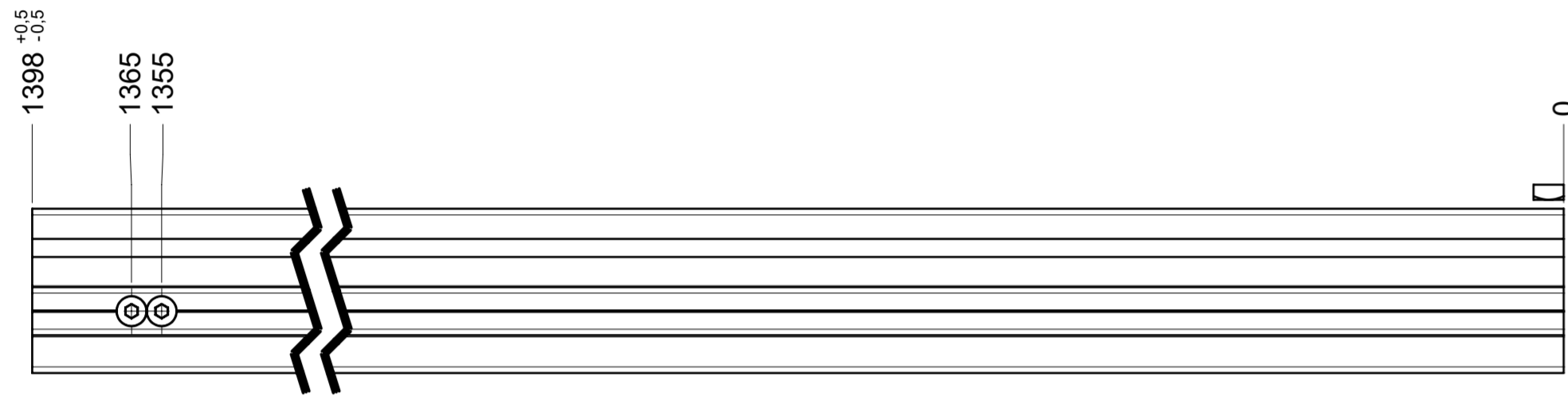
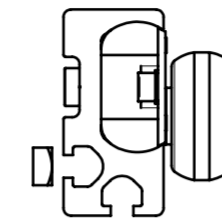
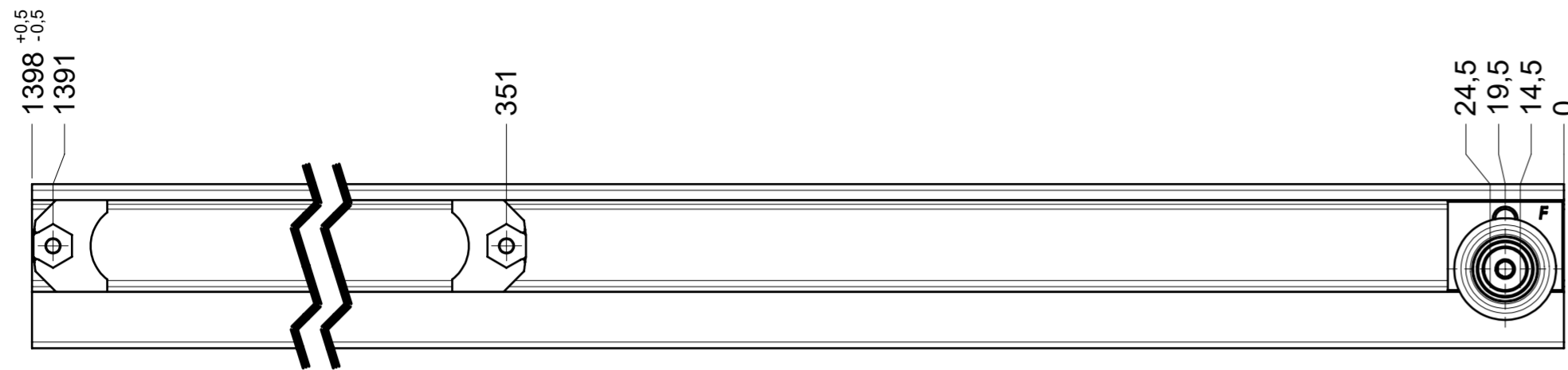

**final approval**

customer name:

signed by:

date:

**all dimensions in mm**

DIN ISO 128-30  
missing dimensions see 3D  
= theor. intersection

This drawing remains our property and may not be multiplied neither be disclosed to third parties (§§1,3 and 5 from the copyright Act (UrhG)) covered according to DIN ISO 16016				scale: 1:2	surface:	material, semi finished parts: CS (technical requirements Fulterer)	A2
(k)				date	name	description: FR 9000 / 140 EN (mm) progressive-action full-extension drawerslide / side mount	drawing number: <b>9000.1400-GA.0000.re</b>
(l)				drawn 01-02-2023	ex		
(h)				proven 01-03-2023	pr		
(g)							
(f)							
(e)				Fulterer AG & Co KG		replaces version date:	
(d)				A-6890 Lustenau / Austria			
(c)				Fulterer AG			
(b)				CH-9430 St. Margrethen			
(a)				ind.	changes	date	na.